

This series of windlasses is specially designed for intensive use and therefore has a robust construction. All windlasses are designed with a self braking gearbox which will save the costs of an expensive brake motor.

The W 1500, W 3400 and W 5600 are our most compact windlasses, standardly executed as double sided windlasses complete with two bandbrakes, free fall clutches and warping heads. These windlasses also can be supplied with stainless steel polished warping heads and a yacht finishing.

The band brakes are lined with a ferodo (non asbestos) friction material.

Standard features:

- Heavy duty worm gearbox or planetary/worm gear combination
- IP 56 TENV cast iron un braked motor 400 VAC / 3 phase / 50 Hz / with torque knob
- Orbit type hydraulic motor
- Suitable for 10 – 28 mm DIN / Studlink chain sizes (other chain-size upon request)
- Free fall clutch
- Band brake
- Horizontal cast iron warping head
- Double layer 2 component conservation, colour BS 20 (Medium Blue)

Available options:

- Double executions possible for W 120 up to W 600 (see drawings)
- Alternative supply voltages
- Full manual control by means of hand wheel
- Horizontal warping head configuration

- Remotely controlled band brakes
- Classification certificate from any recognized marine classification society
- Special marine / offshore coating systems

Available control options:

- Control box IP 55 with IP 65 pendant remote control or push-buttons built acc. to NEN 1010
- Proportional local or remote control valve

Winch type	Chain pull kg.	Chain size din	Chain size stud	Speed m/min.	Bandbrake holding force kg.	Motor power 400 VAC kW	Pressure drop in bar	Flow in l/min.
W 120 E	400	10		10	1200	1,1		
W 150 E	600	10-13	12,5	10	1500	1,8		
W 250 E	750	13-16	12,5	10	2500	2,2		
W 350 E	1200	16	12,5	10	3500	4		
W 400 E	1200	13-16	12,5	10	4000	4		
W 600 E	2400	16-18	16	10	6000	7,5		
PW 1000 E	4000	18-20	17,5-19	10	10000	11		
PW 1600 E	6000	20-22	19-24	10	16000	18,5		
W 120 H	400	10		10	1200		120	20
W 150 H	600	10-13	12,5	10	1500		140	20
W 250 H	750	13-16	12,5	10	2500		100	30
W 350 H	1200	16	12,5	10	3500		120	40
W 400 H	1200	13-16	12,5	10	4000		140	50
W 600 H	2400	16-18	16	10	6000		140	75
P 1000 H	4000	18-20	17,5-19	10	10000		175	50
P 1600 H	6000	20-22	19-24	10	16000		140	75
W 1500 E	1500	16	16	10	4500	5,5		
W 3400 E	3400	18-22	18-22	10	10000	11		
W 5600 E	5600	26-28	26-28	10	16000	18,5		
W 1500 H	1500	16	16	10	4500		70	55
W 3400 H	3400	18-22	18-22	10	10000		105	65
W 5600 H	5600	26-28	26-28	10	16000		135	65

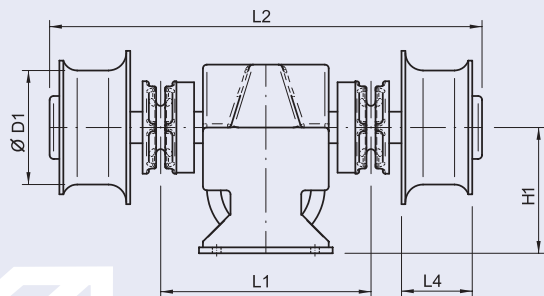

W 1500 / W 3400 / W 5600

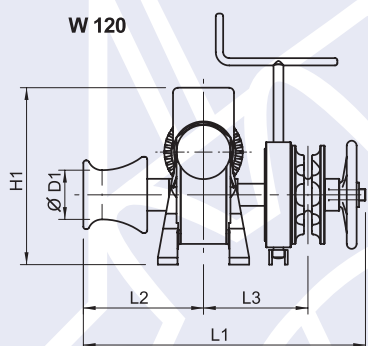

W 120

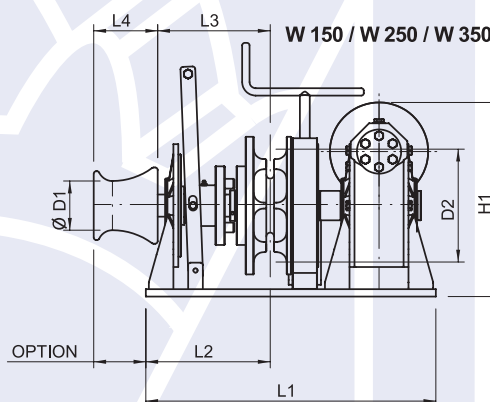

W 150 / W 250 / W 350

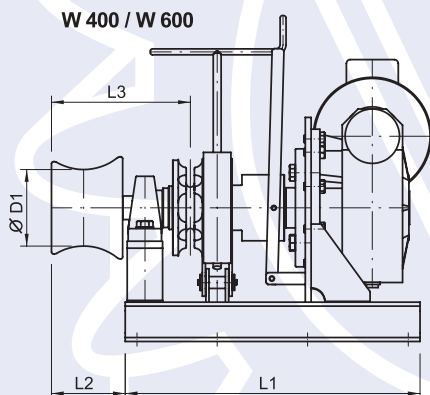

W 400 / W 600

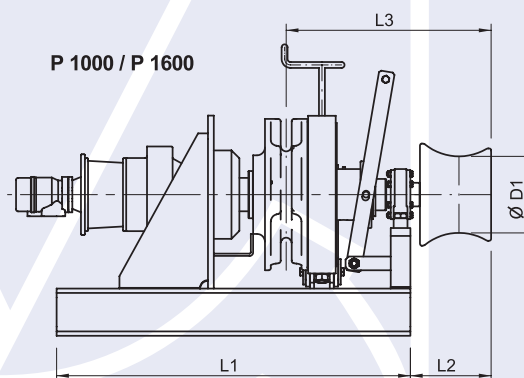

P 1000 / P 1600

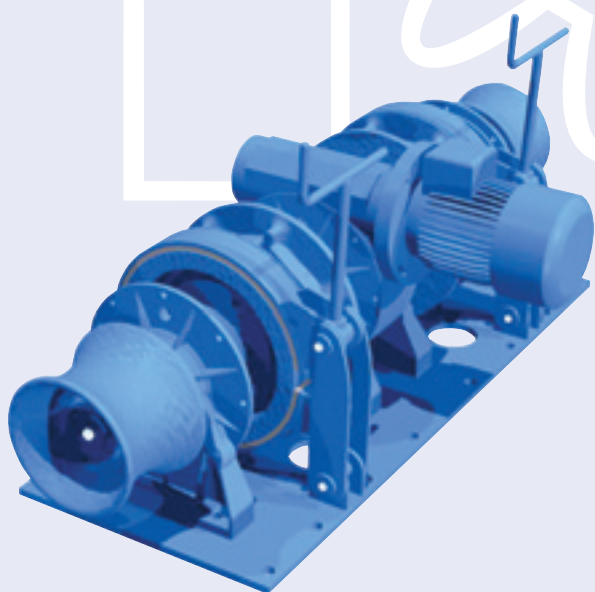

Type	Mass (kg)	D1	D2	L1	L2	L3	L4	H1
W 120	63	100	180	590	255	245	130	295
W 150	140	100	180	590	250	245	130	295
W 250	170	140	190	650	290	280	130	340
W 350	260	195	255	700	305	295	181	385
W 400	240	195	-	700	180	440	-	-
W 600	500	195	-	750	180	460	-	-
P 1000	360	280	-	1300	210	560	-	-
P 1600	500	280	-	1500	210	600	-	-
W 1500	400	200	-	450	850	-	130	250
W 3400	650	290	-	535	1100	-	180	320
W 5600	1100	290	-	660	1270	-	180	395