

REVISION	..				
△x	..		△2x	..	
△3x	..		△4x	..	

It is necessary the fleet angle is 2 degrees or less to prevent the wire rope being unevenly wound to wind the wire rope uniformly.  
Please install the pulley 2670mm or more away from the drum on the drum center line.

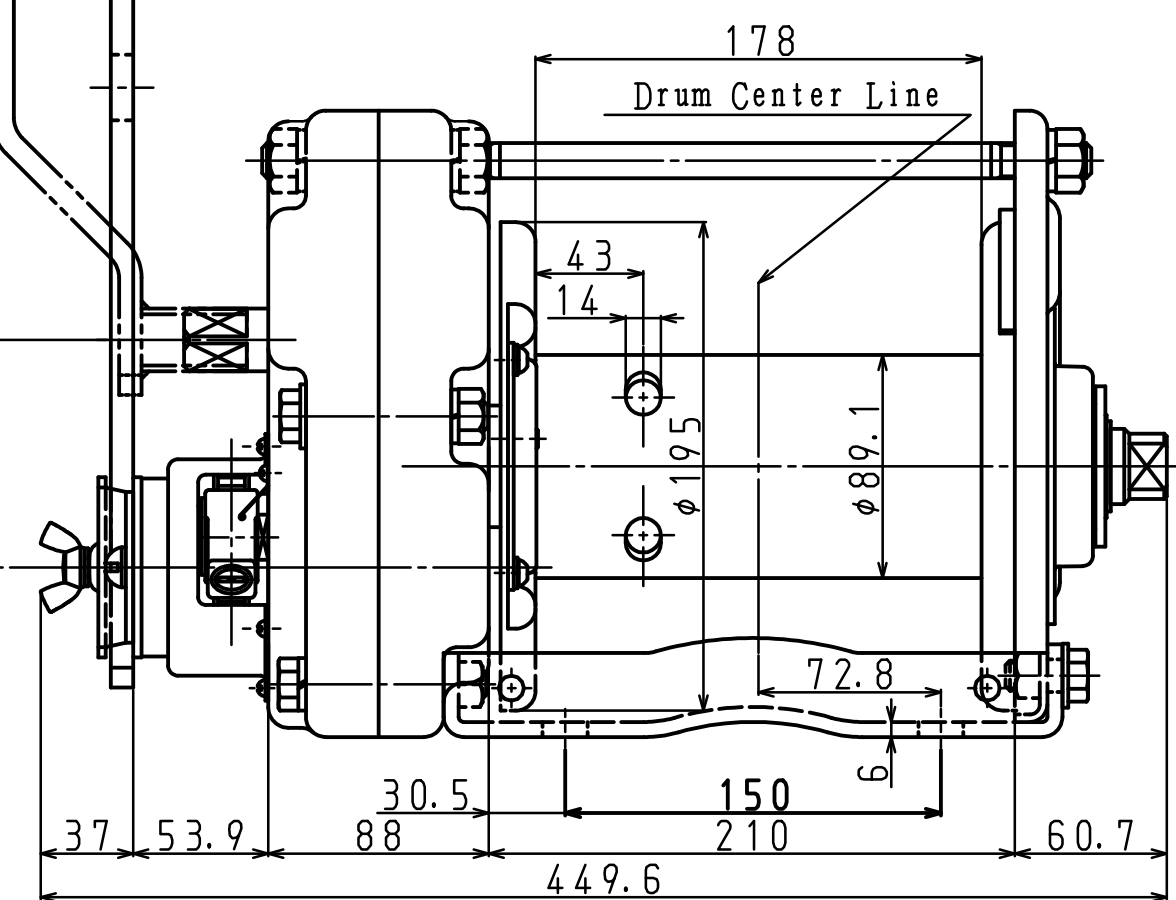

Specifications		(The wire rope composition is a manufacturer recommendation.)		
Model	GM-20	Handle Operation Power	Handle Length 370mm	1st Layer 157N (=16.0kgf)
Load Rating	19,600N (=2,000kgf)		Wire Rope Tension 19,600N	2nd Layer 186N (=18.9kgf)
Wire Rope Tension	(3rd Layer or Less)	Weight (Winch+Handle)	28.2 kg	3rd Layer 214N (=21.8kgf)
Wire Rope Length	φ9mm (6×37)×38m (5th Layer)			
Gear Ratio	Normal : 1/20 *1 Quick : 1/4	Standard Accessories	One Flat Handle One Box Handle	One Hex Wrench for Wire Lock
Handle Length	370mm (Effective Max)			

\*1: Maximum wire rope tension is 3,920N(400kgf) for quick winding.  
Wire rope cannot be wound down with quick winding handle.

MARK	PARTICULARS	MATERIAL	TEST PIECE	WORKING NO. REQUIRED (PER)	SPARE	TOTAL	PER ONE WEIGHT IN #	TOTAL	REMARKS
MANAGER								WORK NO.	QUANTITY
DEPUTY MANAGER								CLASSIFICATION	SCALE
CHIEF	I. Takahashi							DRAWING NO.	GM20-101201-01E
ENG'R IN CHARGE		MAXPULL WINCH							
CHECKED BY		MODEL GM-20							
DRAWN BY	T. Yonezawa								
DATE DRAWN	2010/12/01								

MAXPULL MACHINERY & ENGINEERING CO., LTD.